

City of Sault Ste. Marie

**Queen Street Improvements (Gore to Pim) and Spring Street Waterfront Connector**

Streetscape Enlargement - STA 10+055

Final Concept Design July 22, 2022



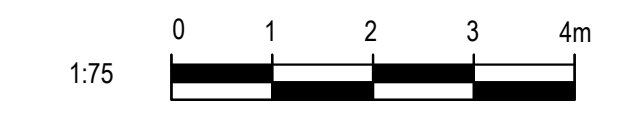
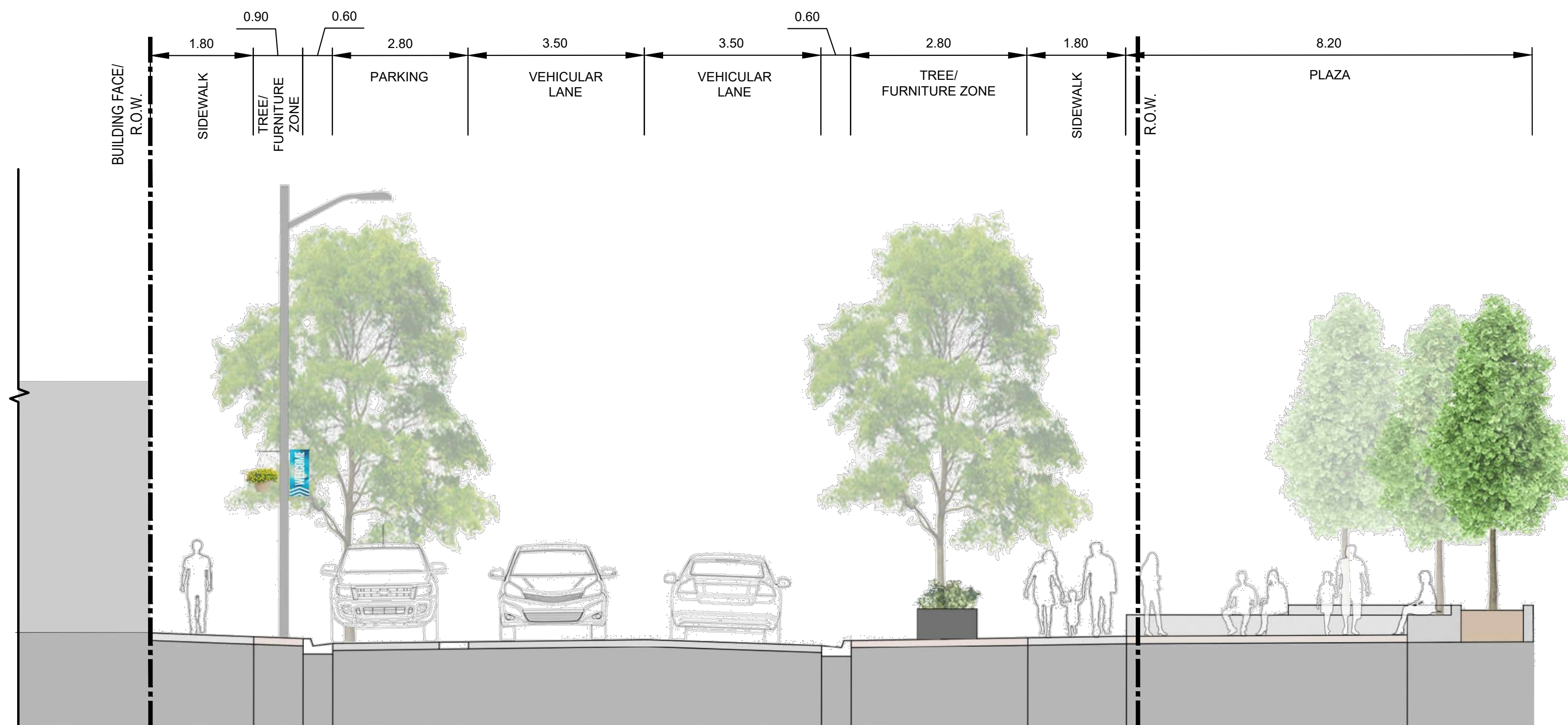

- City standard movable planter
- Cobra-head style light pole
- Bench seating at planter ends
- Raised concrete curb planter

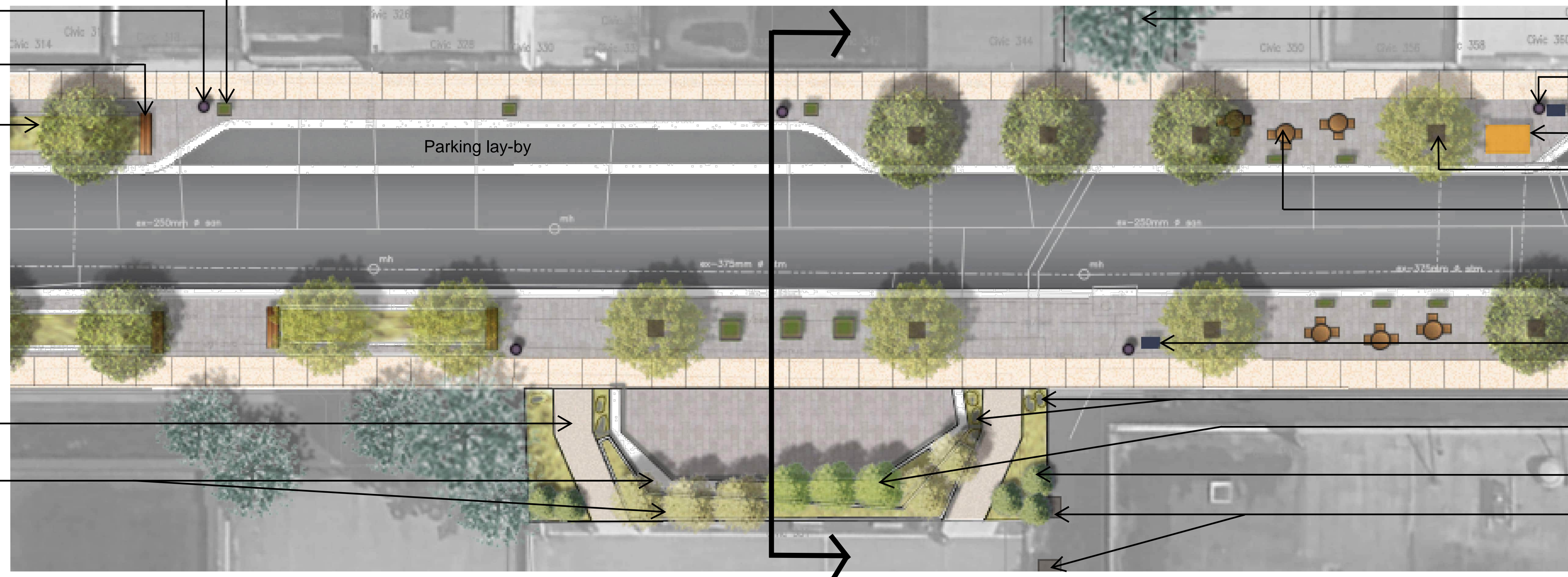

- Walkway connection to parking lot
- Terraced Planters/ Seatwalls (Lower Planter 450mm height, Higher Planter 600mm height)

- Alley connection to King St. Parking Lot
- Cobra-head style light pole
- City standard bus shelter
- Trees in grates with soil cells
- Bistro-style tables and chairs (movable)
- City standard trash receptacle
- Boulders/ Rock cluster
- Pyramidal/ narrow form trees
- Flowering shrubs/ perennials
- Existing transformers

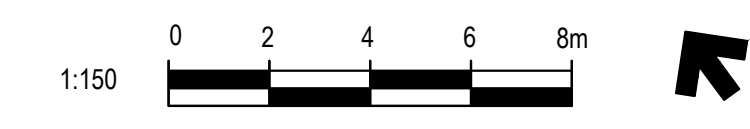

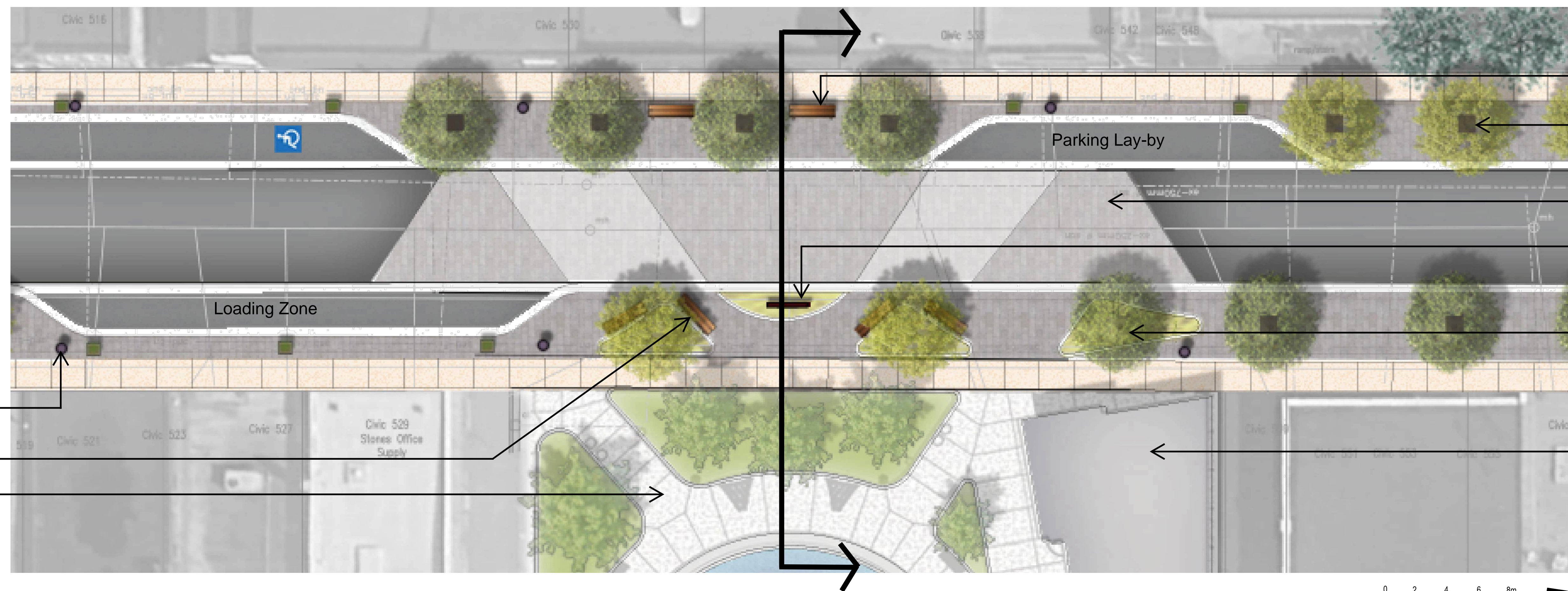
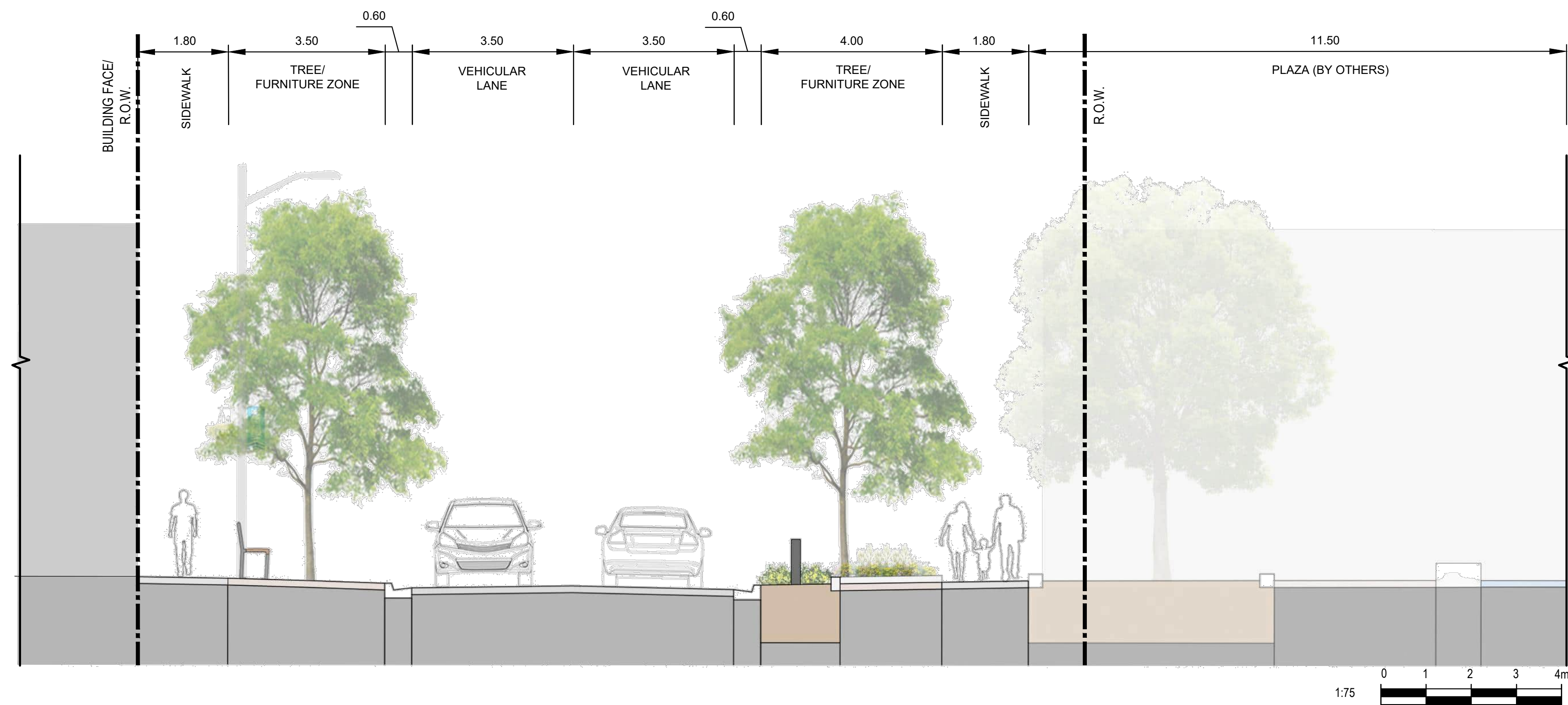

City of Sault Ste. Marie

Queen Street Improvements (Gore to Pim) and Spring Street Waterfront Connector

Streetscape Enlargement - STA 11+215

Final Concept Design July 22, 2022



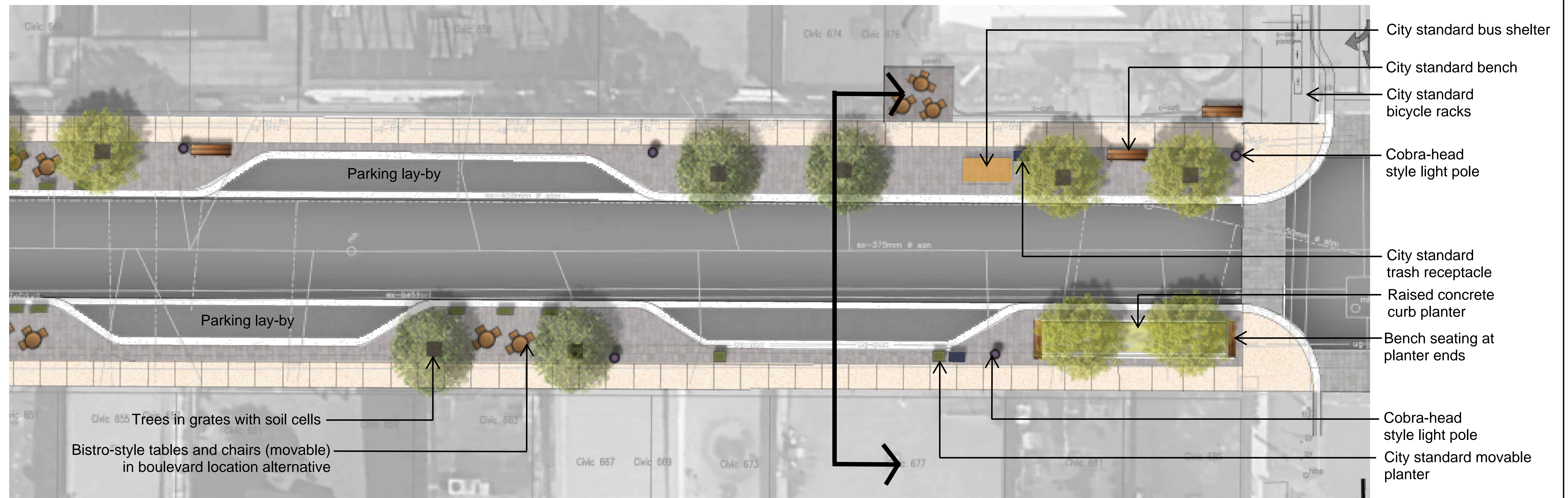
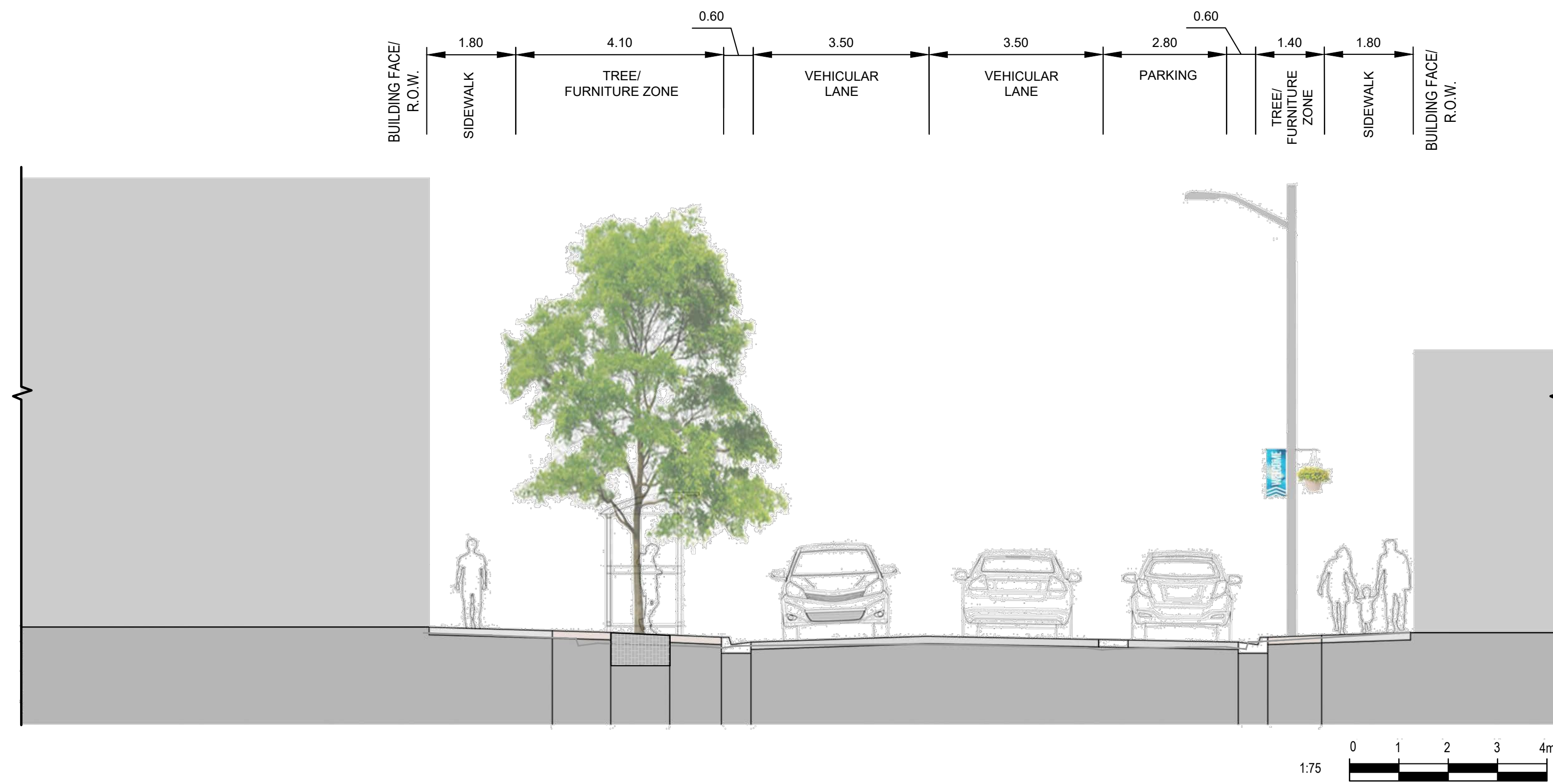

City of Sault Ste. Marie

Queen Street Improvements (Gore to Pim) and Spring Street Waterfront Connector

Streetscape Enlargement - STA 11+466

Final Concept Design July 22, 2022



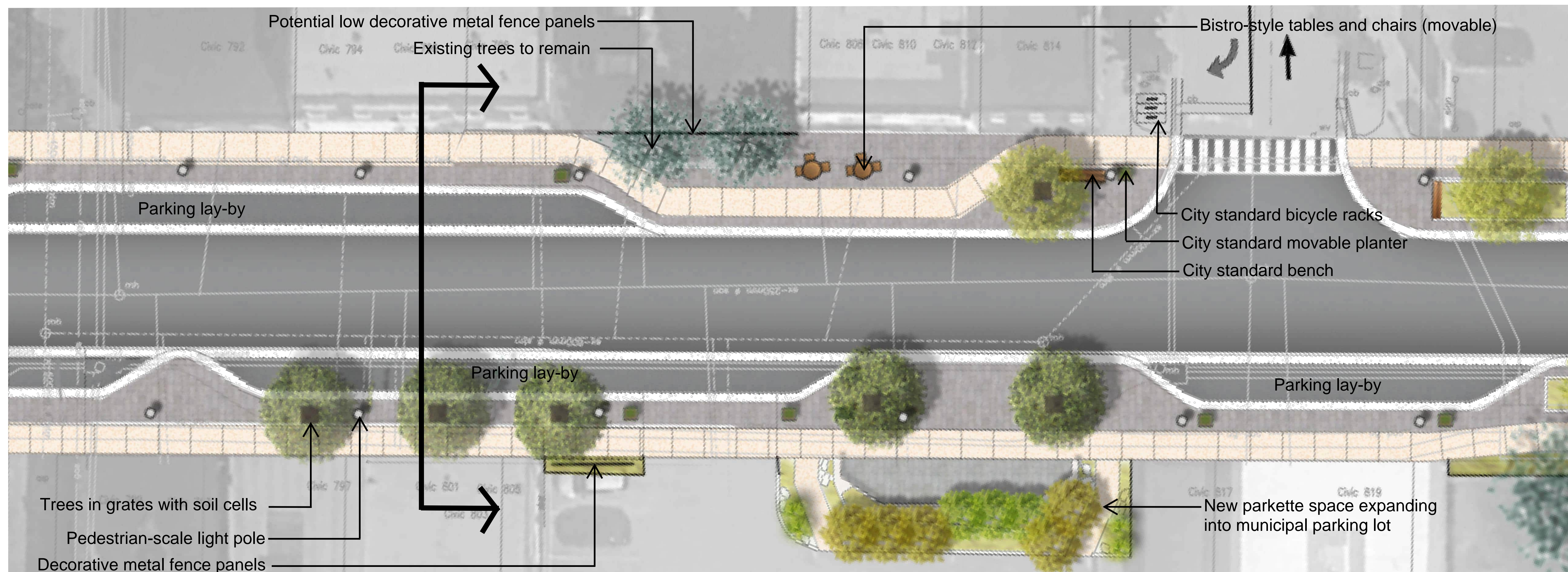
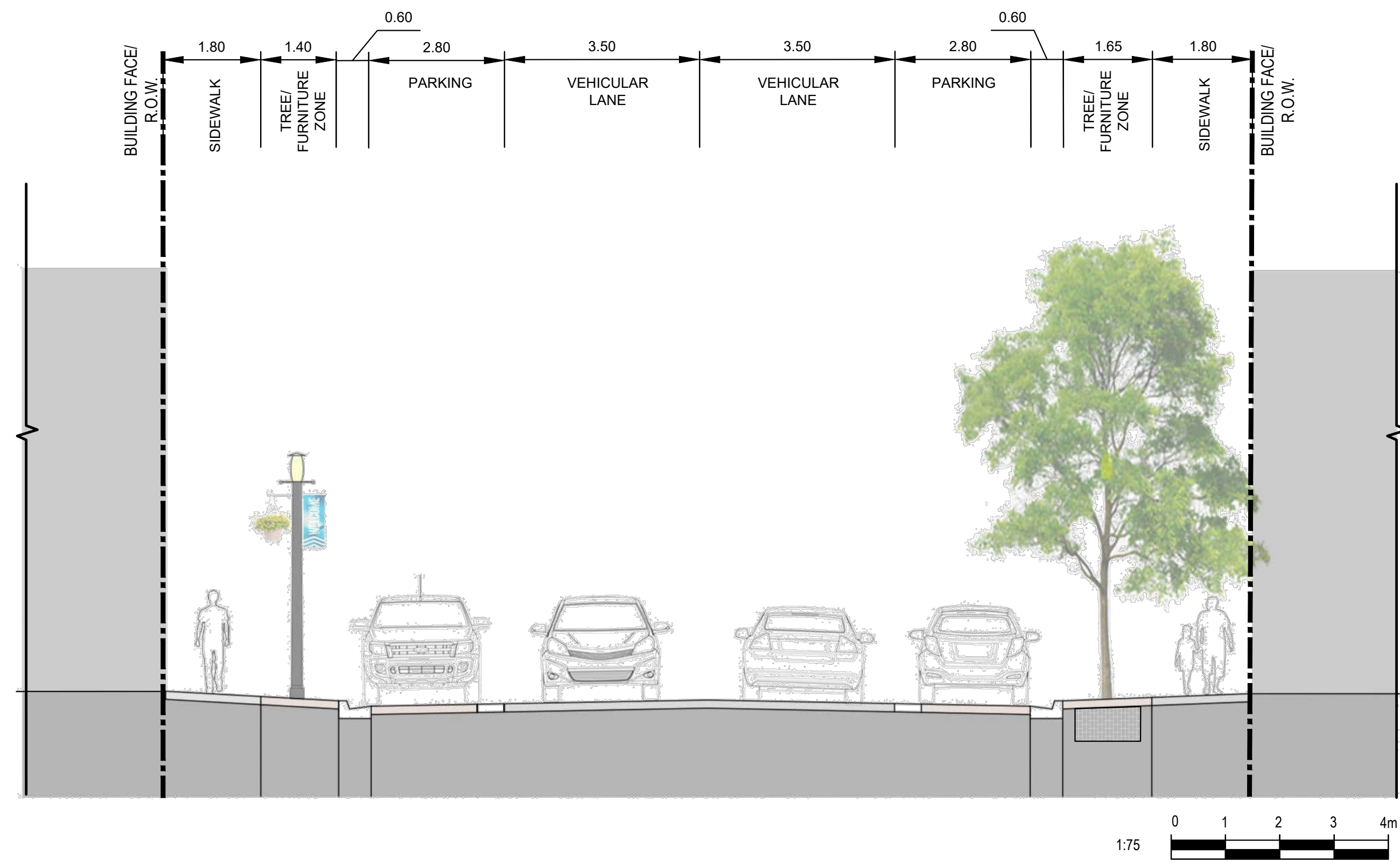

City of Sault Ste. Marie

## Queen Street Improvements (Gore to Pim) and Spring Street Waterfront Connector

Streetscape Enlargement - STA 11+723

Final Concept Design July 22, 2022



**AECOM**